

NOTES:

1. HOLD ROUGH-IN DIMENSIONS ±1/4" (6.4mm)
2. WHEN INSTALLING THIS UNIT, LOCAL, STATE OR FEDERAL CODES SHOULD BE ADHERED TO. FOR INSTALLATION HEIGHTS OTHER THAN SHOWN, DIMENSIONS MARKED (*) MUST BE ADJUSTED ACCORDINGLY.
3. REFER TO 5874/YRKS5874 OPERATION AND MAINTENANCE MANUAL FOR PUSH BUTTON AND VALVE INSTALLATION AND MAINTENANCE INSTRUCTIONS.
4. ROUGH IN DIMENSIONS FOR FOUNTAIN HEIGHTS:

CHILD WHEELCHAIR HEIGHT: SEE SHT 2 FIG 1
 WASTE: 26-1/4" (667mm)
 SUPPLY: 26-1/8" (664mm)
 MOUNTING HOLE: 24-13/16" (630mm)
 MOUNTING PLATE: 23-3/16" (589mm)
 FOUNTAIN: 24" (610mm)
 BUBBLER: 29-7/8" (756mm)

ADULT WHEELCHAIR HEIGHT: SEE SHT 2 FIG 2
 WASTE: 29-1/4" (743mm)
 SUPPLY: 29-1/8" (740mm)
 MOUNTING HOLE: 27-13/16" (706mm)
 MOUNTING PLATE: 26-3/16" (665mm)
 FOUNTAIN: 27" (686mm)
 BUBBLER: 32-7/8" (833mm)

STANDING ADULT HEIGHT: SEE SHT 2 FIG 3
 WASTE: 34-3/4" (883mm)
 SUPPLY: 34-5/8" (879mm)
 MOUNTING HOLE: 33-5/16" (846mm)
 MOUNTING PLATE: 31-11/16" (805mm)
 FOUNTAIN: 32-1/5" (826mm)
 BUBBLER: 38-3/8" (972mm)

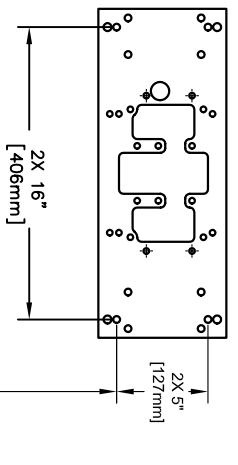

CHILD/ADULT/ ADULT STANDING MOUNTING PLATE

MOUNTING PLATE
 (OPTIONAL, HAWS 6700)

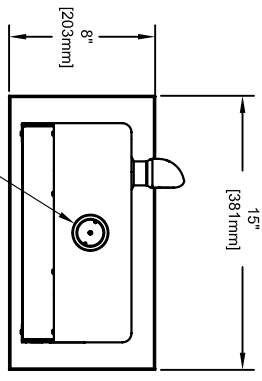

*4.

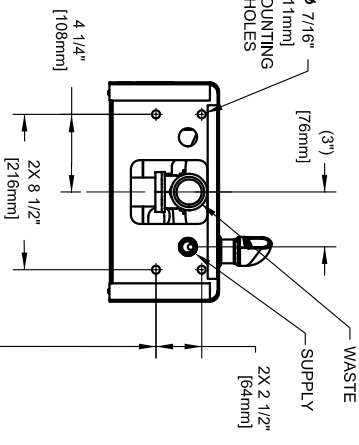

CHILD/ADULT/ ADULT STANDING MOUNTING HOLE

MOUNTING DETAIL
 BACK VIEW

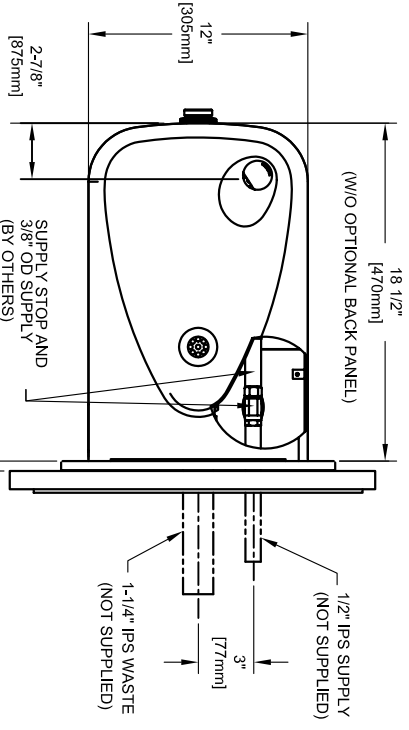

BACK PANEL (OPTIONAL) (SUPPLIED)
 1-1/4" IPS TRAP (OPTIONAL)
 6700 MOUNTING PLATE (OPTIONAL)
 (W/ OPT BACK PANEL)

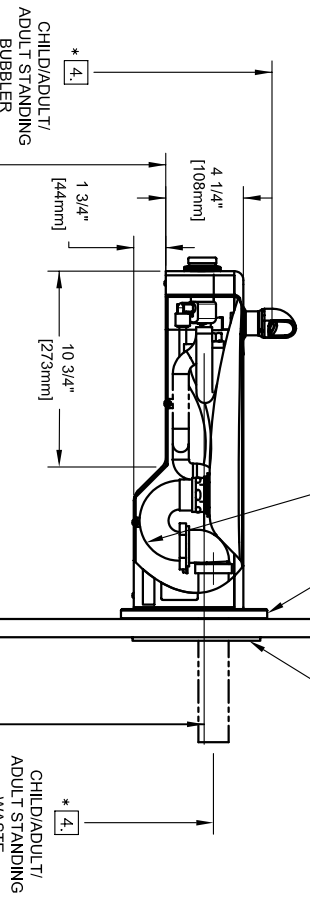

CHILD/ADULT/ ADULT STANDING FOUNTAIN
 CHILD/ADULT/ ADULT STANDING BUBBLER
 CHILD/ADULT/ ADULT STANDING SUPPLY
 CHILD/ADULT/ ADULT STANDING WASTE



HAWS corporation		1455 KLEPPE LANE SPARKS, NEVADA 89431 (775) 359-4712 FAX (775) 359-7424 E-MAIL: HAWS@HAWS.CO.COM WEBSITE: WWW.HAWS.CO.COM	
FORM NO. 1107L	REVISIONS	MODEL(S): 1107L	DATE: 10/06
ISSUED BY: C. FENNER	APPROVED BY: [Signature]	INFO FAX DOC #: 211075	INSTALLATION/FAXBACK
DATE: 10/06	DATE: 10/06	DATE: 10/06	DATE: 10/06
FORM NO. 15267A00	REVISIONS	MODEL(S): 15267A00	DATE: 10/06
ISSUED BY: [Signature]	APPROVED BY: [Signature]	INFO FAX DOC #: 15267A00	INSTALLATION/FAXBACK
DATE: 10/06	DATE: 10/06	DATE: 10/06	DATE: 10/06